



Front dimensions: Ø 30 mm
Panel cut-out: Ø 22.3 mm
Front bezel height: 12 mm
Travel: 6 mm





 Product configurator



DUJX-Basic

Overview DUX-Basic series



- 01 Pushbutton heads
- 02 Emergency-stop heads
- 03 Mushroom heads
- 04 Selector heads
- 05 Toggle heads
- 06 Key actuators

- page 282
- page 283
- page 284
- page 285
- page 289
- page 290

- 07 Pilot light heads / pilot lights
- Contact blocks/lampholders

- page 294
- page 414

Housing colour



degree of protection



operating travel



tactile



illuminating option



labelling option



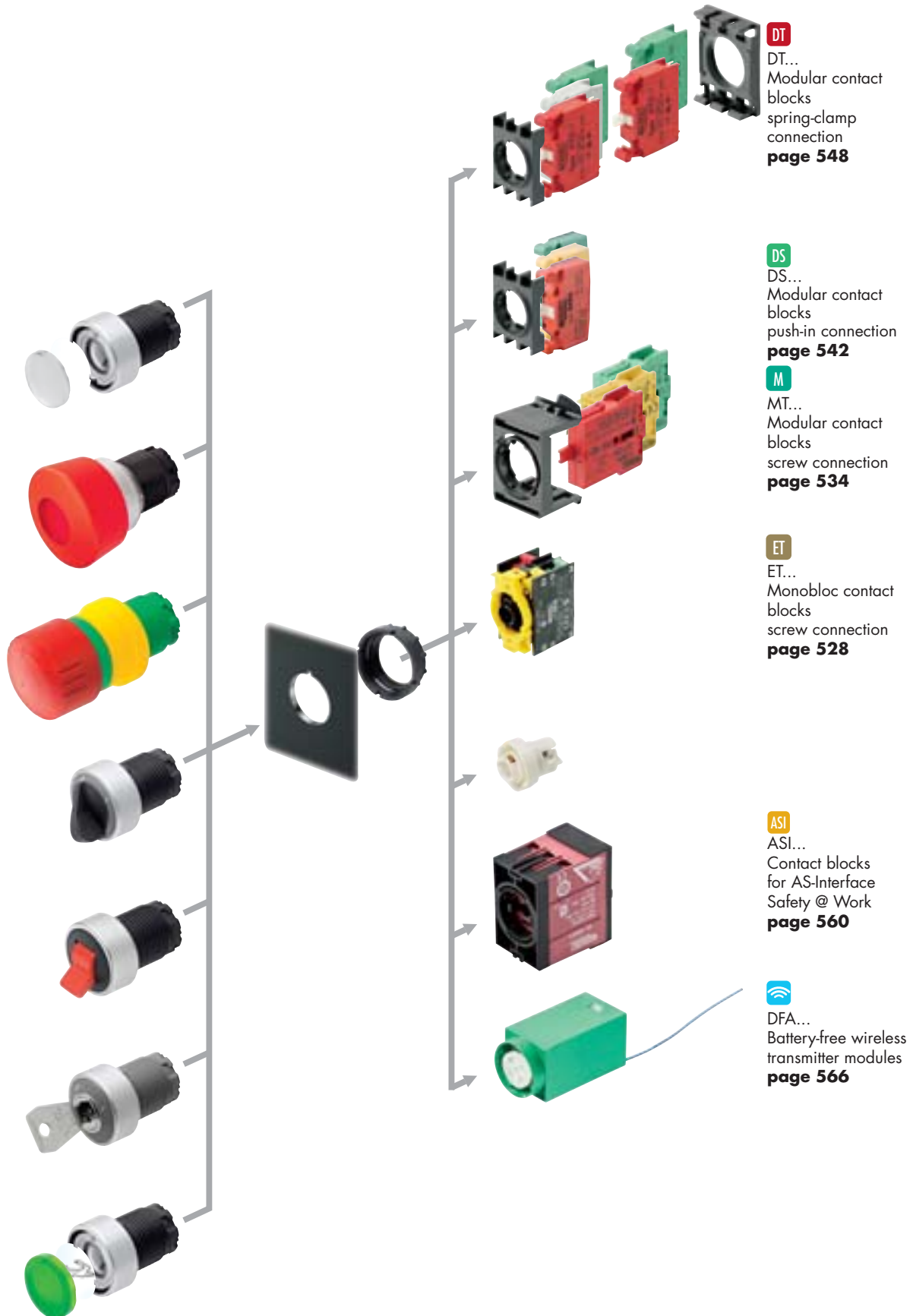

DT
DT...
Modular contact blocks
spring-clamp connection
page 548

DS
DS...
Modular contact blocks
push-in connection
page 542

M
MT...
Modular contact blocks
screw connection
page 534

ET
ET...
Monobloc contact blocks
screw connection
page 528

ASI
ASI...
Contact blocks for AS-Interface
Safety @ Work
page 560

 DFA...
Battery-free wireless transmitter modules
page 566

DUX-Basic

Ø 22.3 mm

MADE IN GERMANY



Mounting depth dimensions

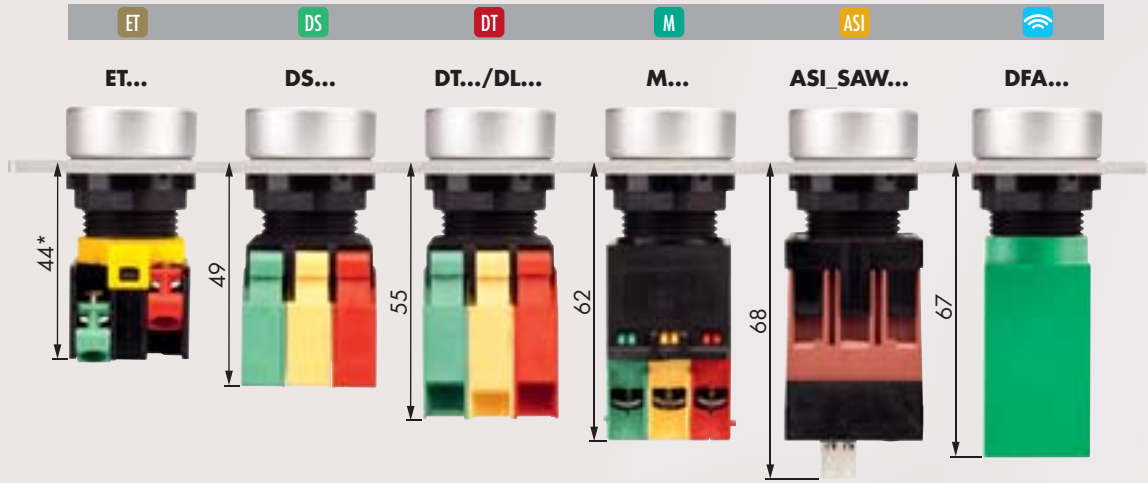

Cutout dimension

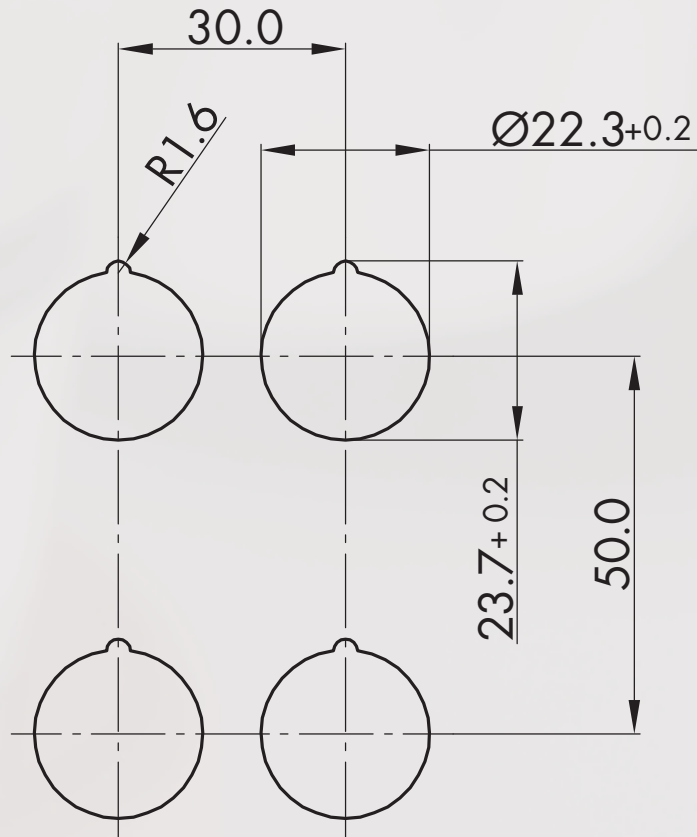

About Us

Pushbuttons
and Switches

Panel Mount Jacks

Emergency-Stop Buttons

Bus Technology

RFD

Enclosures

Pedal Switches

Terminal Blocks

Type Index

Mounting and service instructions

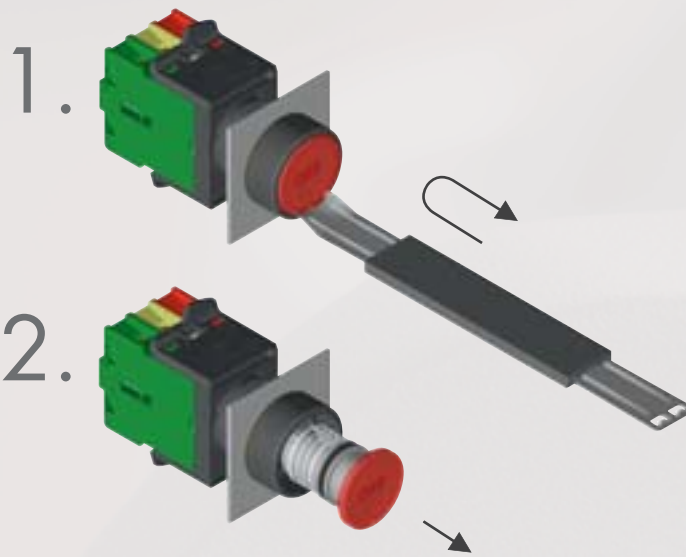

Pushbuttons

Illustration

Dimensions

Description

Type

IP65

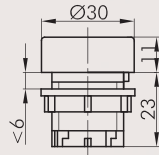

Pushbutton head with flat non-transparent lens

available in white=WS, red=RT, green=GN, yellow=GB, black=SW, blue=BL

add code letter to type number, e.g. DXRTCRT
no inscription, no illumination

suitable contact blocks:



front bezel:

mat
grey
polished
black



DXRTC...
DXRTG...
DXRTM...
DXRTS...

IP65

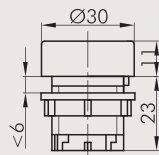

Pushbutton head with flat transparent lens and blank nameplate

available in red=RT, green=GN, yellow=GB, clear=KL, blue=BL
add code letter to type number, e.g. DXRTL CRT

suitable contact blocks:



front bezel:

mat
grey
polished
black

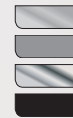

DXRTL...
DXRTL...
DXRTLM...
DXRTLS...

IP65

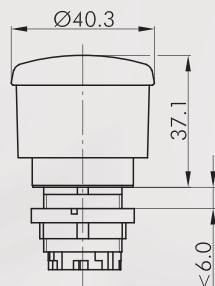

Emergency braking head with inscription

Switching position indicator: yes
Anti-lock collar: no
Release: pull
Standard: EN 60947-5-1, EN 60947-5-5, EN ISO 13850, EN 81-2 Section 15



suitable contact blocks:



front bezel: green
Mushroom head: red
front bezel: black
Mushroom head: red



DXRVG40SS
DXRVS40SS

Emergency-Stops

Illustration

Dimensions

Description

Type

IP65

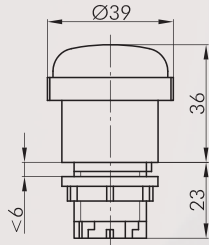

Emergency braking head with arrow

must be mounted onto yellow background!

Switching position indicator:	yes
Permissive Contact:	no
Anti-lock collar:	no
Release:	twist
Standard:	EN 60947-5-1, EN 60947-5-5, EN ISO 13850, EN 81-2 Abschnitt 15



suitable contact blocks:



front bezel:	grey	
Mushroom head:	red	

DXRV39PF

IP65

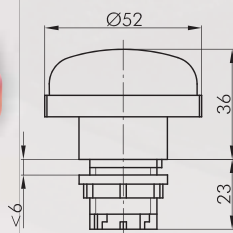
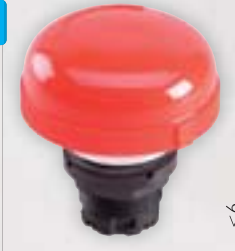

Emergency-stop head

must be mounted onto yellow background!

Switching position indicator:	no
Permissive Contact:	no
Anti-lock collar:	no
Release:	twist
Standard:	EN 60947-5-1, EN 60947-5-5, EN ISO 13850



suitable contact blocks:



front bezel:	polished	
Mushroom head:	red	
front bezel:	grey	
Mushroom head:	red	
front bezel:	black	
Mushroom head:	red	

DXRV52MRT

DXRV52GRT

DXRV52SRT



For further emergency stops, please refer to the chapter "Emergency-stop Heads" starting on page 594

The emergency-stop heads can also be supplied as latching mushroom heads with mushrooms in different colours.

Mushroom Pushbuttons

Illustration

Dimensions

Description

Type

IP65

6 mm

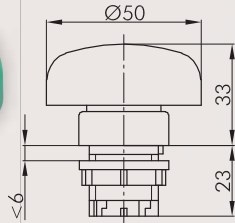
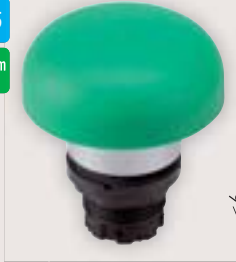

Mushroom head, momentary

mushroom available in red=RT, green=GN, black=SW
add code letters to type number, e.g. DXRS50CRT

suitable contact blocks:

DS DT ET M

front bezel:

mat
grey
polished
black



DXRS50C...
DXRS50G...
DXRS50M...
DXRS50S...

IP65

6 mm

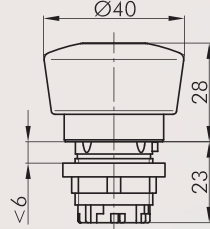

Mushroom head, momentary, with illumination and labelling option

incl. blank nameplate, inscription on request
mushroom available in red=RT, green=GN, black=SW
add code letters to type number, e.g. DXRSL40CRT

suitable contact blocks:

DS DT ET M

Mushroom head, momentary

mushroom available in red=RT, green=GN, black=SW
add code letters to type number, e.g. DXRS40CRT

suitable contact blocks:

DS DT ET M

front bezel:

mat
grey
polished
black



DXRS40C...
DXRS40G...
DXRS40M...
DXRS40S...

IP65

6 mm

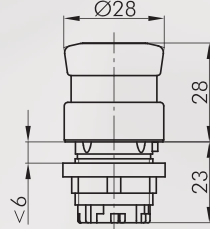

Mushroom head, momentary, with illumination and labelling option

incl. blank nameplate, inscription on request
mushroom available in red=RT, green=GN, black=SW
add code letters to type number, e.g. DXRSL28CRT

suitable contact blocks:

DS DT ET M

front bezel:

mat
grey
polished
black



DXRSL28C...
DXRSL28G...
DXRSL28M...
DXRSL28S...

Selector Switches (momentary/maintained)

I = Switching position
> = Spring return

Illustration

Dimensions

Description

Type

IP65

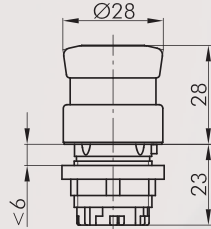

Mushroom head, momentary

mushroom available in red=RT, green=GN, black=SW
add code letters to type number, e.g. DXRS28CRT

suitable contact blocks:



front bezel: mat
grey
polished
black



DXRS28C...
DXRS28G...
DXRS28M...
DXRS28S...

IP65

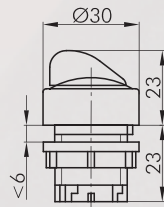

Selector head, maintained

available colour combinations:
black ring / black knob ...SWSW
black ring / grey knob ...SWDG
grey ring / black knob ...DGSW
grey ring / grey knob ...DGDG
add code letters to type number, e.g. DXRWACSWDG

suitable contact blocks:



front bezel: mat
grey
polished
black



DXRWAHC...
DXRWAHG...
DXRWAHM...
DXRWAHS...



suitable contact blocks:



front bezel: mat
grey
polished
black



DXRWBHC...
DXRWBHG...
DXRWBHM...
DXRWBHS...



IP65

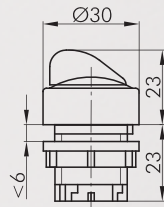

Selector head, momentary

available colour combinations:
black ring / black knob ...SWSW
black ring / grey knob ...SWDG
grey ring / black knob ...DGSW
grey ring / grey knob ...DGDG
add code letters to type number, e.g. DXRSTACSWDG

suitable contact blocks:



front bezel: mat
grey
polished
black



DXRSTAHC...
DXRSTAHG...
DXRSTAHM...
DXRSTAHS...



suitable contact blocks:



front bezel: mat
grey
polished
black



DXRSTBHC...
DXRSTBHG...
DXRSTBHM...
DXRSTBHS...



DUX-Basic

Ø 22.3 mm

MADE IN GERMANY



About Us

Selector Switches (momentary/maintained)

I = Switching position
> = Spring return

Pushbuttons
and Switches

Panel Mount Jacks

Emergency-Stop Buttons

Bus Technology

RFD

Enclosures

Pedal Switches

Terminal Blocks

Type Index

Illustration

Dimensions

Description

Type

IP65

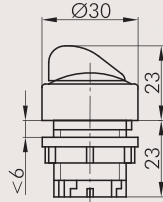

Selector head, left maintained, right momentary

available colour combinations:
 black ring / black knob ...SWSW
 black ring / grey knob ...SWDG
 grey ring / black knob ...DGSW
 grey ring / grey knob ...DGDG
 add code letters to type number, e.g. DXRWCCSWDG

suitable contact blocks:



front bezel: mat grey polished black

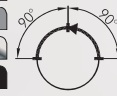

DXRWCHC...
 DXRWCHG...
 DXRWCHM...
 DXRWCHS...

IP65

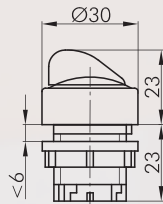

Selector head, left momentary, right maintained

available colour combinations:
 black ring / black knob ...SWSW
 black ring / grey knob ...SWDG
 grey ring / black knob ...DGSW
 grey ring / grey knob ...DGDG
 add code letters to type number, e.g. DXRWDCSWDG

suitable contact blocks:



front bezel: mat grey polished black

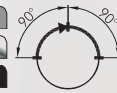

DXRWDHC...
 DXRWDHG...
 DXRWDHM...
 DXRWDHS...

Selector Switches (momentary/maintained)

I = Switching position
> = Spring return

Illustration

Dimensions

Description

Type

IP65

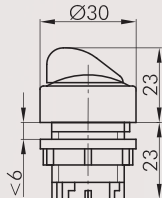

Selector head with ring illumination, maintained

available colour combinations:

- red ring / black knob ...RTSW
 - red ring / grey knob ...RTDG
 - green ring / black knob ...GNSW
 - green ring / grey knob ...GNDG
 - clear ring / black knob ...KLSW
 - clear ring / grey knob ...KLDG
- add code letters to type number, e.g. DXRWALCRTSW

suitable contact blocks:



front bezel:

- mat
- grey
- polished
- black

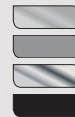

- DXRWALHC...
- DXRWALHG...
- DXRWALHM...
- DXRWALHS...

suitable contact blocks:



front bezel:

- mat
- grey
- polished
- black

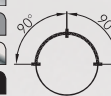

- DXRWBLHC...
- DXRWBLHG...
- DXRWBLHM...
- DXRWBLHS...

About Us

→ Pushbuttons and Switches

Panel Mount Jacks

Emergency-Stop Buttons

Bus Technology

RFID

Enclosures

Pedal Switches

Terminal Blocks

Type Index

Selector Switches (momentary/maintained)

I = Switching position
> = Spring return

Illustration

Dimensions

Description

Type

IP65

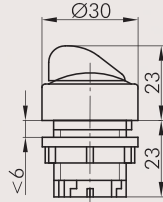

Selector head, momentary, with ring illumination

available colour combinations:

red ring / black knob	...RTSW
red ring / grey knob	...RTDG
green ring / black knob	...GNSW
green ring / grey knob	...GNDG
clear ring / black knob	...KLSW
clear ring / grey knob	...KLDG

add code letters to type number, e.g. DXRSTALCRTSW

suitable contact blocks:



front bezel:

mat	
grey	
polished	
black	



DXRSTALHC...
DXRSTALHG...
DXRSTALHM...
DXRSTALHS...

suitable contact blocks:



front bezel:

mat	
grey	
polished	
black	



DXRSTBLHC...
DXRSTBLHG...
DXRSTBLHM...
DXRSTBLHS...

IP65

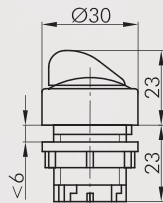

Selector head with ring illumination, left maintained, right momentary

available colour combinations:

red ring / black knob	...RTSW
red ring / grey knob	...RTDG
green ring / black knob	...GNSW
green ring / grey knob	...GNDG
clear ring / black knob	...KLSW
clear ring / grey knob	...KLDG

add code letters to type number, e.g. DXRWCLCRTSW

suitable contact blocks:



front bezel:

mat	
grey	
polished	
black	



DXRWCLHC...
DXRWCLHG...
DXRWCLHM...
DXRWCLHS...

Selector Switches (momentary/maintained)

Illustration

Dimensions

Description

Type

IP65

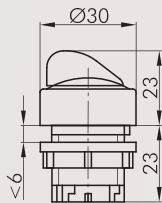

Selector head with ring illumination, left momentary, right maintained

available colour combinations

- red ring / black knob ...RTSW
 - red ring / grey knob ...RTDG
 - green ring / black knob ...GNSW
 - green ring / grey knob ...GNDG
 - clear ring / black knob ...KLSW
 - clear ring / grey knob ...KLDG
- add code letters to type number, e.g. DXRWDLCRTSW

suitable contact blocks:



front bezel:

- mat
- grey
- polished
- black



- DXRWDLHC...
- DXRWDLHG...
- DXRWDLHM...
- DXRWDLHS...

IP65

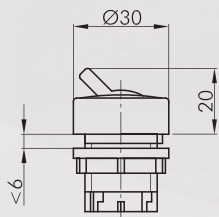

Toggle head, maintained

available colour combinations:

- black ring / black toggle ...SWSW
 - black ring / red toggle ...SWRT
 - black ring / white toggle ...SWWS
 - grey ring / black toggle ...DGSW
 - grey ring / red toggle ...DGRT
 - grey ring / white toggle ...DGWS
- Add code letters to type number, e.g. DXRKCSWSW

suitable contact blocks:



front bezel:

- mat
- grey
- polished
- black



- DXRKC...
- DXRKG...
- DXRKM...
- DXRKS...

DUX-Basic

Ø 22.3 mm

MADE IN GERMANY



About Us

Key Switches (momentary/maintained)

I = Switching position
> = Spring return
O = Key removable position

Illustration

Dimensions

Description

Type

IP65

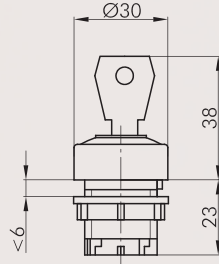

Key actuator, momentary

including two keys
available colour combinations:
black ring ...SW...
grey ring ...DG...
add code letters to type number, e.g. DXRSSACDG12
other lock types on request

suitable contact blocks:



front bezel: mat
grey
polished
black



DXRSSAC...12
DXRSSAG...12
DXRSSAM...12
DXRSSAS...12

suitable contact blocks:



front bezel: mat
grey
polished
black



DXRSSAC...13
DXRSSAG...13
DXRSSAM...13
DXRSSAS...13

suitable contact blocks:



front bezel mat
grey
polished
black



DXRSSAC...17
DXRSSAG...17
DXRSSAM...17
DXRSSAS...17

suitable contact blocks:



front bezel: mat
grey
polished
black



DXRSSAC...18
DXRSSAG...18
DXRSSAM...18
DXRSSAS...18

Pushbuttons
and Switches

Panel Mount Jacks

Emergency-Stop Buttons

Bus Technology

RFD

Enclosures

Pedal Switches

Terminal Blocks

Type Index

Key Switches (momentary/maintained)

I = Switching position
> = Spring return
O = Key removable position

Illustration

Dimensions

Description

Type

IP65

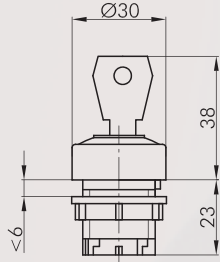

Key actuator, momentary

including two keys
available colour combinations:
black ring ...SW...
grey ring ...DG...
add code letters to type number, e.g. DXRSSACDG23
other lock types on request

suitable contact blocks:



front bezel: mat
grey
polished
black



DXRSSAC...23
DXRSSAG...23
DXRSSAM...23
DXRSSAS...23

suitable contact blocks:



front bezel: mat
grey
polished
black



DXRSSAC...27
DXRSSAG...27
DXRSSAM...27
DXRSSAS...27

IP65

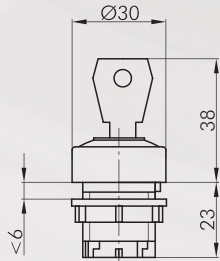

Key actuator maintained/left, momentary/right

including two keys
available colour combinations:
black ring ...SW...
grey ring ...DG...
add code letters to type number, e.g. DXRSSACDG24
other lock types on request

suitable contact blocks:



front bezel: mat
grey
polished
black



DXRSSAC...24
DXRSSAG...24
DXRSSAM...24
DXRSSAS...24

About Us

→ Pushbuttons and Switches

Panel Mount Jacks

Emergency-Stop Buttons

Bus Technology

RFID

Enclosures

Pedal Switches

Terminal Blocks

Type Index

Key Switches (momentary/maintained)

I = Switching position
> = Spring return
O = Key removable position

Illustration

Dimensions

Description

Type

IP65

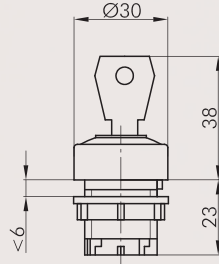

Key actuator with ring illumination, latching

including two keys
available colour combinations:
red ring ...RT...
green ring ...GN...
clear ring ...KL...
add code letters to type number, e.g. DXRSSALCRT12
other lock types on request
accepts only LEDs!

suitable contact blocks:



front bezel: mat
grey
polished
black

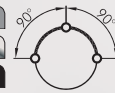

DXRSSALC...12
DXRSSALG...12
DXRSSALM...12
DXRSSALS...12

suitable contact blocks:



front bezel: mat
grey
polished
black

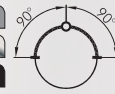

DXRSSALC...13
DXRSSALG...13
DXRSSALM...13
DXRSSALS...13

suitable contact blocks:



front bezel: mat
grey
polished
black



DXRSSALC...17
DXRSSALG...17
DXRSSALM...17
DXRSSALS...17

suitable contact blocks:



front bezel: mat
grey
polished
black

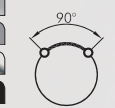

DXRSSALC...18
DXRSSALG...18
DXRSSALM...18
DXRSSALS...18

Key Switches (momentary/maintained)

I = Switching position
> = Spring return
O = Key removable position

Illustration

Dimensions

Description

Type

IP65

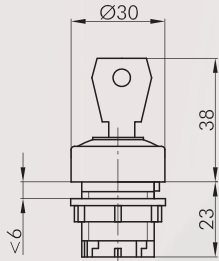

Key actuator with ring illumination, momentary

including two keys
available colour combinations:

- red ring ...RT...
- green ring ...GN...
- clear ring ...KL...

add code letters to type number, e.g. DXRSSALCRT23

other lock types on request

accepts only LEDs !

suitable contact blocks:



front bezel:

- mat
- grey
- polished
- black

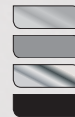

- DXRSSALC...23
- DXRSSALG...23
- DXRSSALM...23
- DXRSSALS...23

suitable contact blocks:



front bezel:

- mat
- grey
- polished
- black



- DXRSSALC...27
- DXRSSALG...27
- DXRSSALM...27
- DXRSSALS...27

IP65

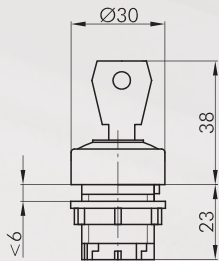

Key actuator with ring illumination maintained/left, momentary/right

including two keys
available colour combinations:

- red ring ...RT...
- green ring ...GN...
- clear ring ...KL...

add code letters to type number, e.g. DXRSSALCRT24

other lock types on request

accepts only LEDs !

suitable contact blocks:



front bezel:

- mat
- grey
- silver-coloured
- black



- DXRSSALC...24
- DXRSSALG...24
- DXRSSALM...24
- DXRSSALS...24

About Us

→ Pushbuttons and Switches

Panel Mount Jacks

Emergency-Stop Buttons

Bus Technology

RFID

Enclosures

Pedal Switches

Terminal Blocks

Type Index

Pilot Lights

Illustration

Dimensions

Description

Type

IP65

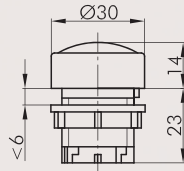

Pilot light head with transparent convex lens

available in
red=RT, green=GN, yellow=GB, clear=KL, blue=BL
add code letters to type number, e.g. DXRNKCRT

suitable lampholders:

DS DT ET M

front bezel: mat
grey
polished
black



DXRNKC...
DXRNKG...
DXRNKM...
DXRNKS...

IP65

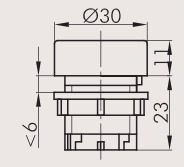

Pilot light head with transparent flat lens

available in
red=RT, green=GN, yellow=GB, clear=KL, blue=BL
add code letters to type number, e.g. DXRNFCRT

suitable lampholders:

DS DT ET M

front bezel: mat
grey
polished
black

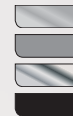

DXRNFC...
DXRNFG...
DXRNFM...
DXRNFS...

Accessories



Mounting tool 22

with torque limitation
for the series QUARTEX-R(-JUWEL), KOMBITAST-R-JUWEL,
RONDEX, RONDEX-M, RONDEX-JUWEL, RVA, DUX-Basic,
SHORTRON, jacks of the ranges RONTRON-R/-Q-JUWEL

S22



Mounting tool adapter with 1/4" connections

for mounting tools S16 and S22

SRA

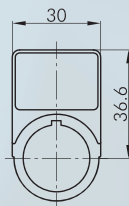

External nameplate holder

for outside marking of the actuators of the DUX-Basic series
accepts self-adhesive nameplates

colour: black



DRABT









Self-adhesive nameplate, laser-printed

inscription according to customer's specification
dimensions: 19 x 27 mm

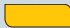
BZ23L...

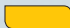
Accessories for Pushbuttons and Switches

Illustration	Dimensions	Description	Type
		Self-adhesive nameplate blank dimensions: 19 x 27 mm	BZ23U
		Self-adhesive nameplate with standard imprint please specify index number(see nameplates from page 634) dimensions: 19 x 27 mm	BZ23B...
		Yellow nameplate self-adhesive PVC foil printing on request outer dia. 75 mm for mounting dia. 22.3 mm colour: yellow 	NAS_22
		Yellow nameplate with quadrilingual imprint self-adhesive PVC foil outer dia. 75 mm for mounting dia. 22.3 mm colour: yellow 	NAS_22_548
		Universal lens remover	USK