



General Data

Type reference: F RTP(O)(I)(OO)(III)(OI)(OOI)(OII)(S)(3O)(_AU)
 Description: Contact block with PCB-mount terminals, separate plungers, bolt fastening
 Approvals: cURus, ENEC10, VDE, CE, TÜV_Süd
 Contact type: 1NC / 1NO / 2NC / 1NC + 1NO / 2NO / 2NC + 1NO / 1NC + 2NO / 3NO / 3NC
 Operation travel: 2.3 mm
 Connection type: PCB-mount terminals
 Contact material: AgNi / AgNi, gold-plated 5µm
 Max. storage temperature: -40°C ... 80°C
 Max. operating temperature: -25°C ... 70°C
 Mechanical life: 600.000
 Electrical life (rated load): 600,000
 Contact resistance NO: < 20 mOhm (new state)
 Contact resistance NC: < 20 mOhm (new state)
 Min. current: 1 mA (under laboratory conditions)
 Min. voltage: 5 V
 Bouncing time NC: < 10ms
 Positive opening contact: acc. to EN60947-5-1, appendix K

Electrical data acc. to IEC/EN 60947-5-1 (VDE 0660 Sect. 200)

	alternate current	direct current
Utilisation category:	AC15 B300	DC13 Q300
Rated insulation voltage Ui:	250 V	250V
Rated operating voltage Ue:	240V / 120V	250V / 125V / 60V / 24V
Rated operating current Ie:	1.5A / 3A	0.27 A / 0.55 A / 1 A / 2 A
Breaking capacity:	10Ie	1,1Ie
Continuous thermal current:	5A	

Electrical data acc. to IEC/EN 61058-1 (VDE 0630 Sect. 1)

Rated voltage Ue: 250 V~
 Rated current Ie: 6(4) A

Electrical features - 5µm gold-plating, type addition _AU

Switching voltage: 20mV ... 42V AC/DC
 Switching current: 1mA ... 250mA

Note

O = NC contact; I = NO contact
 For illumination with Schlegel LED type FRTLED3UW
 DC13: 100.000 switching cycles (at maximum switching capacity)
 Life time with emergency-stop head: 30.000 (RKUV28, RRJUV)
 6050 (RXJUV)
 With illumination (LED): overvoltage category II (2.5kV), pollution degree 2
 Versions with 3 contacts: overvoltage category II (2.5kV), pollution degree 2

The contact blocks must not be used individually.
 At least 2 contact blocks have to be mounted onto the PCB and they have to be arranged by 180° offset.
 F RTP...(S)...:
 With safety contact for failure switch-off.
 The safety contact (NO contact) is always closed in the operating state and opens when the actuator and contact block are separated.
 In order to use the failure switch-off, the NO contact is connected in series with the NC contact.
 UL approval for: F RTP(L)(O)(I)(OO)(III)(OI)(III)(OOO)(OOI)(OII)(S)(_AU)(xV)(_RO)

Contact blocks FRTP...

PCB-mount terminals

made in germany



About Us

Bushbuttrons/Switches
→ Contact Blocks

Panel Mount Jacks

Emergency-Stop Buttons

Bus Technology

RFD

Enclosures

Pedal Switches

Terminal Blocks

Type Index

1.

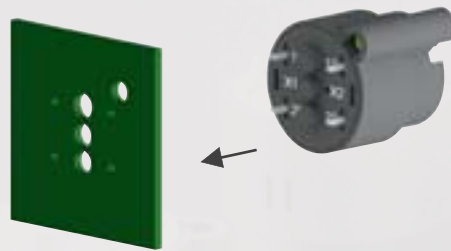

2.

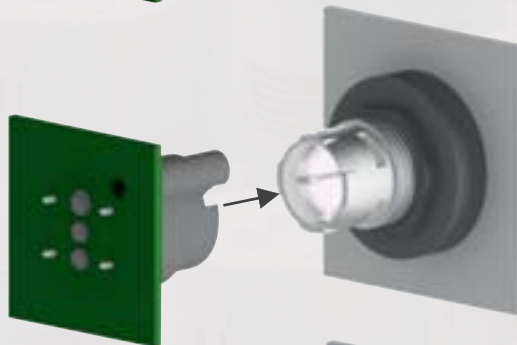

3.

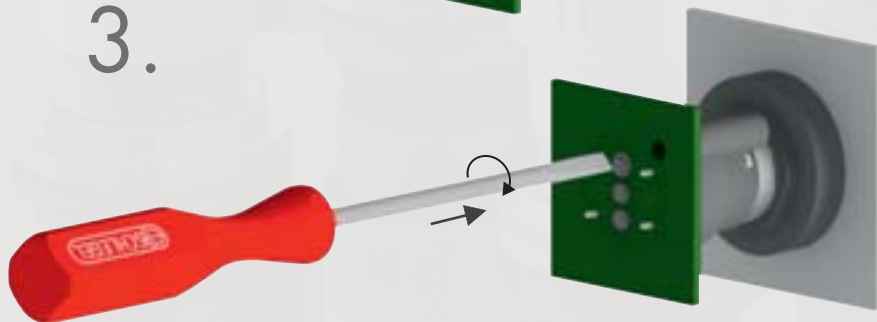

Illustration

Description

Type

IP00

2.3mm

0 1 2

13/14

Contact block, momentary
1NO

PCB-mount terminals

Optionally as illuminated momentary contact block with LED type FRTLED3UW. There are two holes on the bottom of the housing to conduct the LED.

suitable pushbuttons and switches:

Contact material: AgNi **FRTP1**
AgNi, gold-plated **FRTP1_AU**

IP00

2.3mm

0 1 2

PIN 1/ PIN 2
PIN 1/ PIN 4
PIN 3 n.c.

13 14
23 24

Contact block, momentary
2NO

PCB-mount terminals

Optionally as illuminated momentary contact block with LED type FRTLED3UW. There are two holes on the bottom of the housing to conduct the LED.

suitable pushbuttons and switches:

Contact material: AgNi **FRTP11**
AgNi, gold-plated **FRTP11_AU**

IP00

2.3mm

0 1 2

11/12

Contact block, momentary
1NC

PCB-mount terminals

Optionally as illuminated momentary contact block with LED type FRTLED3UW. There are two holes on the bottom of the housing to conduct the LED.

suitable pushbuttons and switches:

Contact material: AgNi **FRTP0**
AgNi, gold-plated **FRTP0_AU**

Contact blocks FRTP...

PCB-mount terminals

MADE IN GERMANY



Illustration

Description

Type

IP00



11/12
21/22

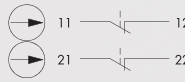

Contact block, momentary

2NC

PCB-mount terminals
Optionally as illuminated momentary contact block with LED type FRTLED3UW. There are two holes on the bottom of the housing to conduct the LED.

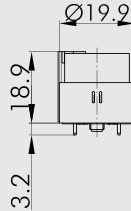
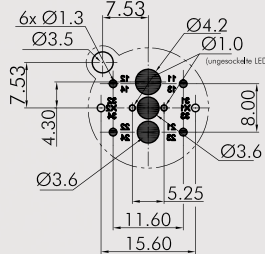

suitable pushbuttons and switches:



Contact material: AgNi **FRTPO0**
AgNi, gold-plated **FRTPO0_AU**

IP00



11/12
23/24

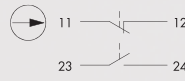

Contact block, momentary

1NC + 1NO

PCB-mount terminals
Optionally as illuminated momentary contact block with LED type FRTLED3UW. There are two holes on the bottom of the housing to conduct the LED.

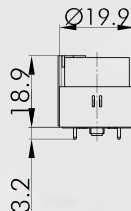
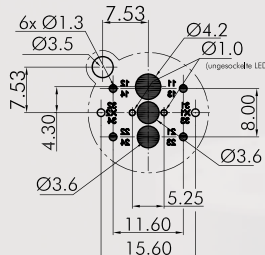

suitable pushbuttons and switches:



Contact material: AgNi **FRTPOI**
AgNi, gold-plated **FRTPOI_AU**

IP00



11/12
33/34
21/22

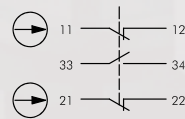

Contact block, momentary

2NC + 1NO

PCB-mount terminals

suitable pushbuttons and switches:



Contact material: AgNi **FRTPOOI**
AgNi, gold-plated **FRTPOOI_AU**

Accessories

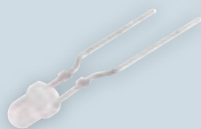

Ultra-bright LED 3mm

ready-made for FRTP...

Connection type: solder pins (wire diameter 0.5 mm)

Colour: white **FRTLED3UW**

About Us

Busbuttons / Switches

Panel Mount Jacks

Emergency-Stop Buttons

Bus Technology

RFID

Enclosures

Pedal Switches

Terminal Blocks

Type Index



About Us

Bushbuttons/Switches
→ Contact Blocks

Panel Mount Jacks

Emergency-Stop Buttons

Bus Technology

RFID

Enclosures

Pedal Switches

Terminal Blocks

Type Index